

# GROUND FLOOR PLAN

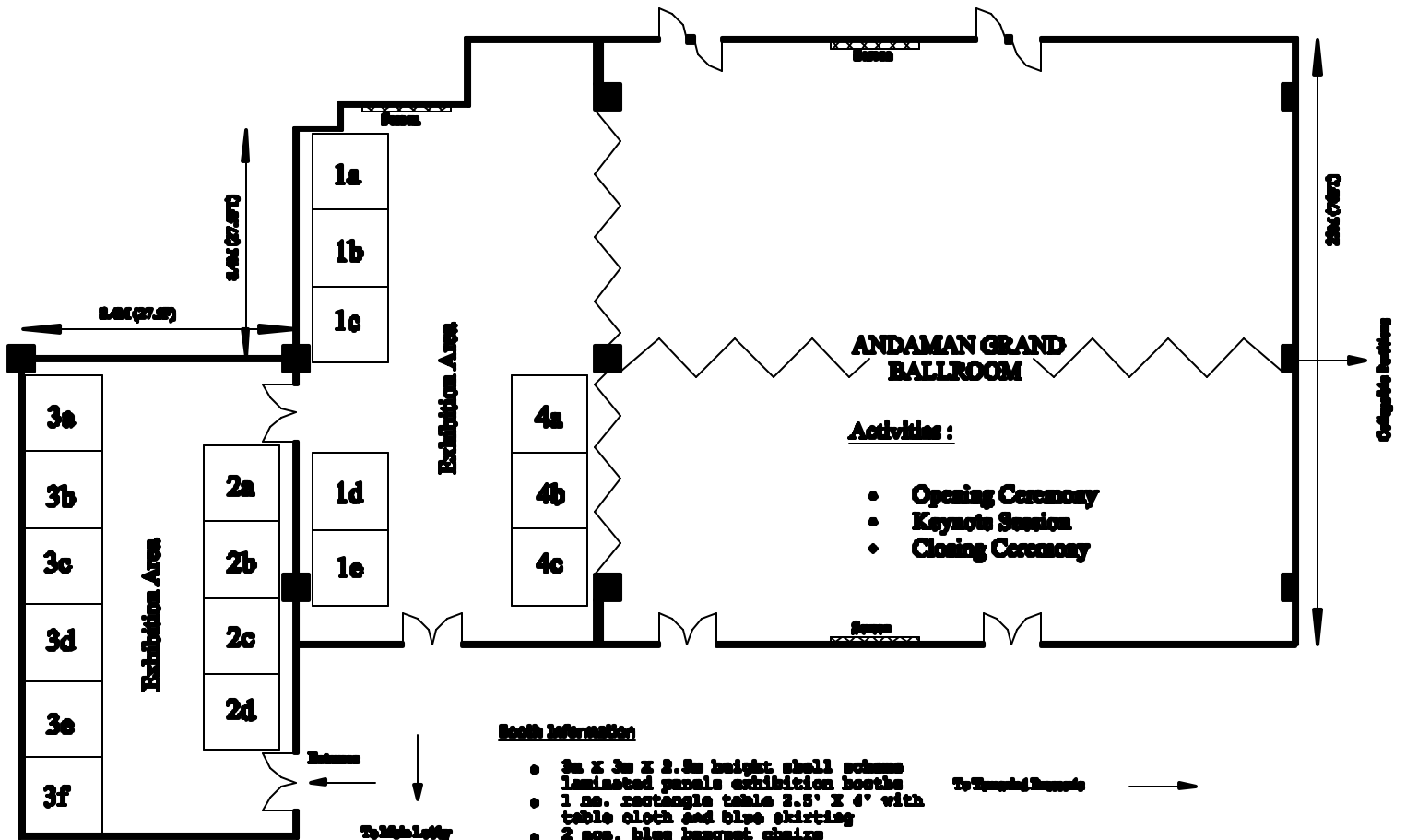

**Note : Plan Not to Scale**

**Booth Information**

- 3m X 3m X 2.8m height shell scheme laminated panels exhibition booths
- 1 no. rectangular table 2.5' X 4' with table cloth and blue skirting
- 2 nos. blue banquet chairs
- 1 no. 15 amp power point
- 2 nos. fluorescent tubes 36w
- 1 no. waste paper basket
- 1 set company's name on 2.75" (70) blue PVC stickers not exceeding 30 characters and including logo
- 100 sq. ft. good used blue needle punch carpet

**BOOTH CONFIRMATION**

- 1a - E-SPATIAL RESOURCES SDN. BHD.
- 1b - JABATAN UKUR DAN PEMETAAN MALAYSIA (JUPEM)
- 1c - GLOBAL-TRAK SYSTEMS SDN. BHD.
- 1d - SKY-SHINE CORPORATION (M) SDN. BHD.
- 1e - SOIL INSTRUMENT (M) SDN. BHD.
  
- 2a - AUTODESK
- 2b - KUALA LUMPUR INFRASTRUCTURE UNIVERSITY COLLEGE (KLIUC)
- 2c - MALAYSIAN CENTRE FOR REMOTE SENSING (MACRES)
- 2d - ESRI SOUTH ASIA SDN. BHD.
  
- 3a - MAP INFORMATION SOLUTIONS SDN. BHD.
- 3b - JURUPRO SDN. BHD.
- 3c - SYARIKAT E.J. MOTIWALLA
- 3d - PERBADANAN PEMANGUNAN PULAU PINANG (PDC)
- 3e - BENTLEY SYSTEM SDN. BHD.
- 3f - MALAYSIAN CENTRE FOR GEOSPATIAL DATA INFRASTRUCTURE (MCGDI)
  
- 4a - GEOMATIKA TECHNOLOGY SDN. BHD. / HYDRONAV SERVICES (S) PTE. LTD.
- 4b - EQUARATER (PENANG) SDN. BHD.
- 4c - HEWLETT-PACKARD (M) SDN. BHD.